

020 3965 7777

office@altoresidential.co.uk

altoresidential.co.uk

ALTO
RESIDENTIAL



Falcondale Court, Lakeside Drive, London, NW10 7FR
£2,300 PCM



Floor Plan



Falcondale Court NW10
Approx. Gross Internal Area = 806 sq ft / 74.8 sq m

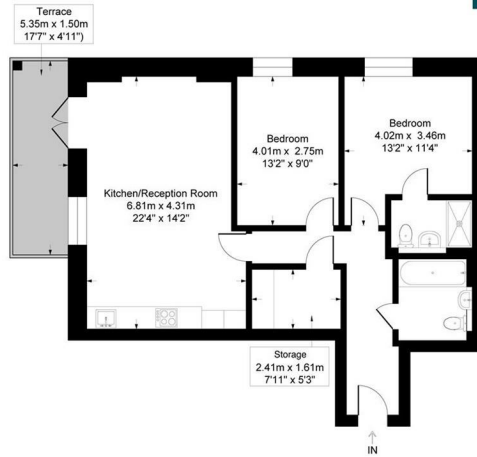

This plan is for layout guidance only. Not drawn to scale unless states, windows and door openings are approximate, whilst every care is taken in the preparation of this plan, please check all dimensions shapes and compass bearings making any decisions reliant upon them. (ID614943)

Area Map

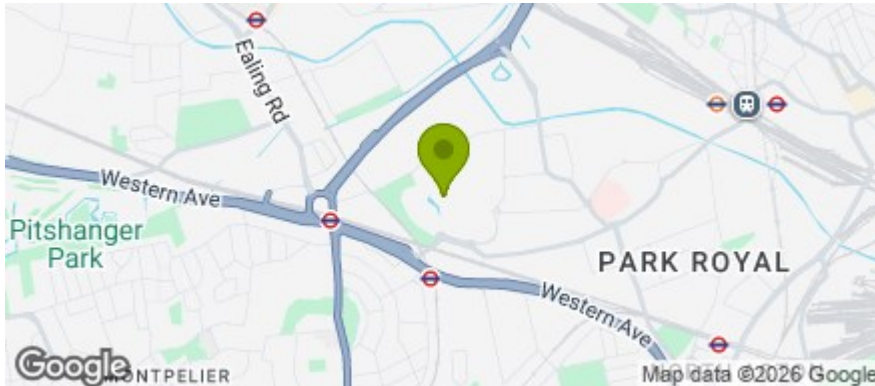

Accommodation

- TWO DOUBLE BEDROOMS
- RESIDENTS GYM
- ALLOCATED PARKING
- PRIVATE TERRACE
- TWO BATHROOMS
- LARGE UTILITY ROOM



Viewing

Please contact us on 020 3965 7777 if you wish to arrange a viewing appointment for this property or require further information.

Energy Efficiency Graph

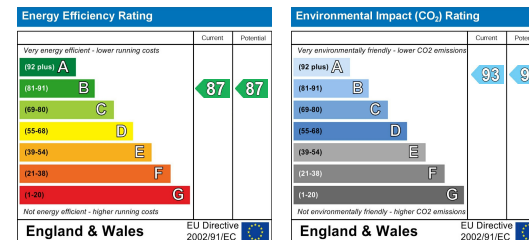

These particulars, whilst believed to be accurate are set out as a general outline only for guidance and do not constitute any part of an offer or contract. Intending purchasers should not rely on them as statements of representation of fact, but must satisfy themselves by inspection or otherwise as to their accuracy. No person in this firm's employment has the authority to make or give any representation or warranty in respect of the property.